

SNAPPER™

A HIGH SECURITY* PLASTIC COATED METAL BOLT SEAL

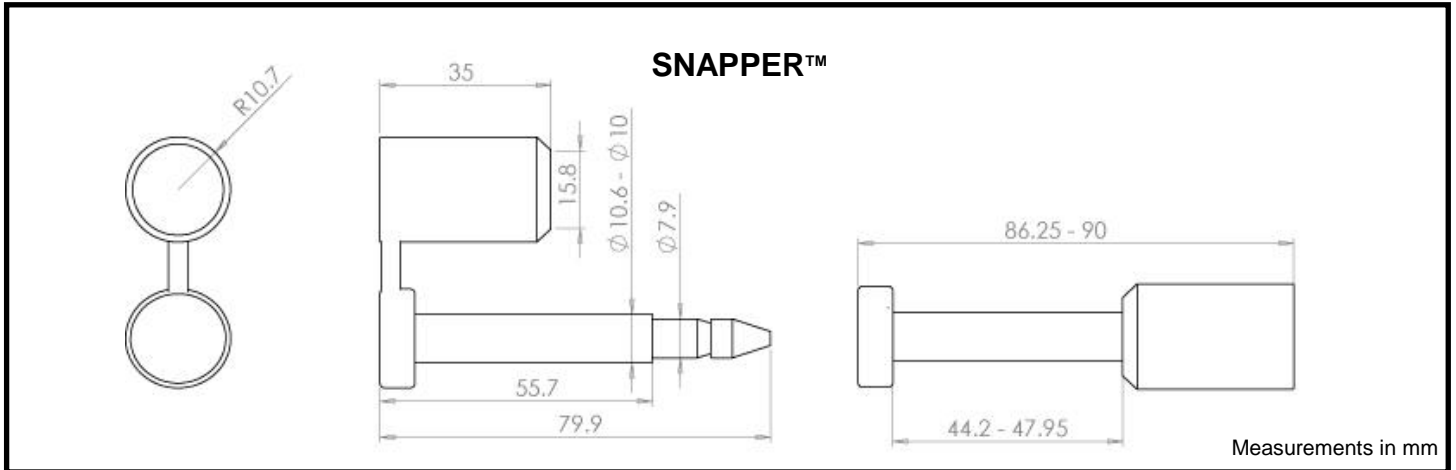

FEATURES

- C-TPAT compliant High security seal
- Plastic coating will show evidence of tampering while also protecting against corrosion
- Patented locking mechanism provides easy locking and a high tensile strength
- Laser marked numbering on both bolt and body

SPECIFICATION

Materials:

Bolt & Body: Steel
Plastic coating: PS

Average mechanical strengths (ISO/PAS 17712):

Tensile strength: approx. 19.4kN (equivalent to ~1940kg)
Shear strength: approx. 907.2kgf
Bending strength: approx. 62.5Nm
Impact strength: > 40.7J

Recommended Operational Temperature Range*:

Snapper: -10°C to +50°C
(NB: all material is increasingly brittle with decreasing temp.)

Customs classification:

*ISO/PAS 17712: High Security Seal

Minimum hole size for bolt to pass through:

10.5mm diameter

Stock Colours:

AASNY: Bolt & Body plastic coating: Yellow

Stock Markings:

Bolt & Body end: embossed Envoseal logo
Bolt & Body side: laser marked 6 digit serial number with 2 letter prefix

Packaging:

Snapper: 250pcs per box, 600x200x190mm, 15kgs

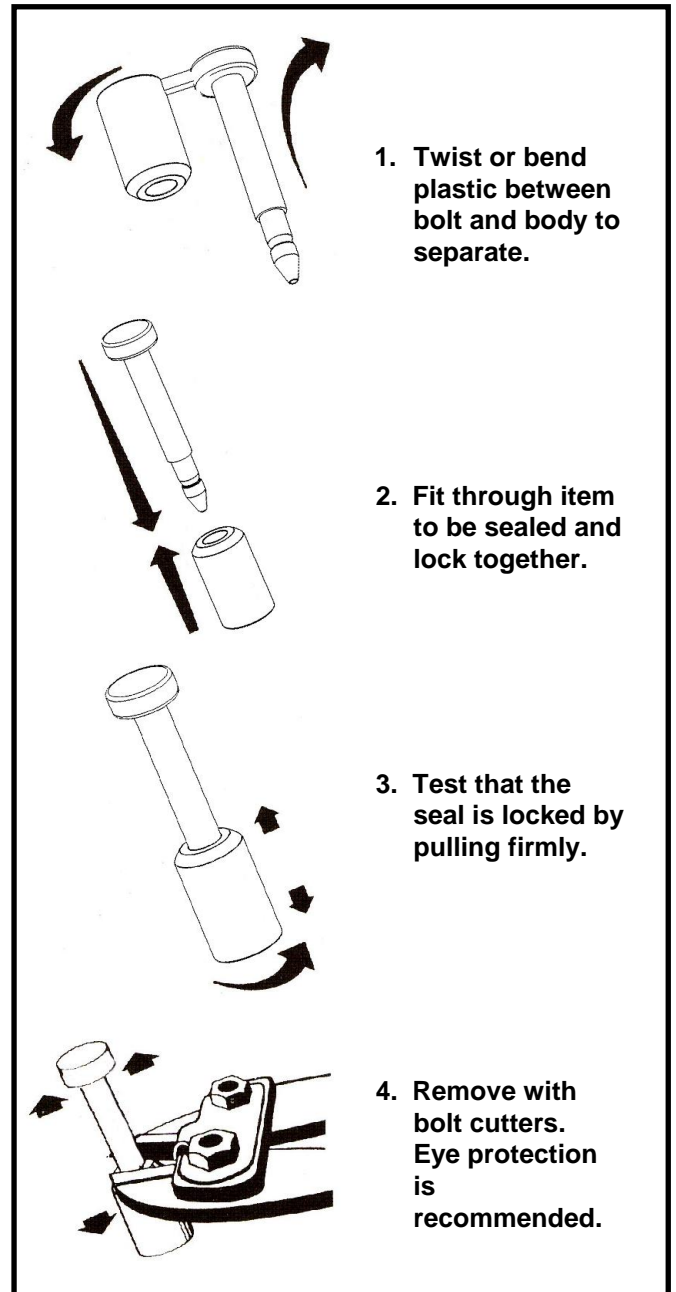



CUSTOMISATION

All customisation available upon request only for orders above:

Snapper: 10,000

Custom Marking:

Bolt & Body end: embossed custom logo

Bolt & Body side: laser marked

- custom text/logo
- up to 12 digit numbering possible
- 6 digit bar-coding possible on certain colours
- print area: bolt = 4 x 25mm, body = 12 x 25mm

Custom Colours:

Bolt & Body plastic coating: choice of colours (both bolt and body are the same colour)

Note: colours for bar-coding must be light/pale

Custom bolts:

Custom bolts are available in different lengths and with cranked shafts.

Note that custom bolts are not coated with plastic and hence not numbered.

APPLICATIONS

- Vehicle doors
- Shipping containers

TYPICAL RAW MATERIAL SAFETY AND PROPERTIES

	PS	Steel
Health & Safety	The material is not hazardous. However, care should be taken when applying and removing a seal.	The material is not hazardous. However, care should be taken when applying and removing a seal.
Storage & handling	Keep in secure, dry & well ventilated place at room temperature, away from direct sunlight and protect from contamination.	Keep in secure, dry & well ventilated place at room temperature and protect from contamination.
Disposal of used seals	This product is not bio-degradable. It should be incinerated or land filled in compliance with local authority regulations.	Material should be recycled or otherwise disposed of in compliance with local authority regulations.
Flammability	UL 94: HB	N/A
In case of fire	Water spray, foam or dry powder may be used. Self contained breathing apparatus should be used.	Dry powder or sand should be used.
Melting point	PS will melt at approx. 190 degrees centigrade.	Steel will melt at approx. 1500 degrees centigrade.

Note: Boxes should not be stacked more than 5 boxes high to avoid crushing. Care should be taken when removing a seal, being especially cautious of sharp metal edges.

All values are typical values as published and are for guidance only. ITW Envopak reserves the right to alter these specifications without notice. The above safety information has been extracted from material safety data sheets supplied by our raw material suppliers. No liability is taken by ITW Envopak for the accuracy of this information.

*Recommended operational temperature range is a guide only. The seal can withstand more extreme temperatures depending on conditions. For temperatures outside the recommended range seals should first be tested in the specific application by the customer.